

Well Maintained 25,519 sf Industrial Space **FOR SUBLEASE**



★ **120 Calle Iglesia Unit A, San Clemente** ★

HIGHLIGHTS

- 25,519 SF Total Size
- 3,000 SF Office Area
- 22,519 SF Warehouse Area
- 24'-26' Warehouse Clearance
- Amps: 600 (verify)
- 2-story Lobby
- 2 - Oversize Ground Level Doors
- Recently renovated offices, conference room
- Breakroom
- 85 Non-Exclusive Parking Stalls
- **Rate: \$1.83/sf Gross per month**



For More Information, Please Contact: **949.366.2020**



SCAN OR CLICK
TO VIEW
WEBSITE

ROB JOHNSTON, President

Lic# 01121630
rob@johnston-pacific.com

LOUIS JOHNSTON, Vice President

Lic# 02054162
louis@johnston-pacific.com

JOHNSTON PACIFIC
COMMERCIAL REAL ESTATE, INC.

www.johnston-pacific.com

The information above had been obtained from sources believed to be reliable. While we do not doubt its accuracy, we have not verified it, make no guarantee, warranty or representation about it. It is your responsibility to independently confirm its accuracy and completeness. All information is subject to change without notice.

PROPERTY PHOTOS



FLOOR PLAN

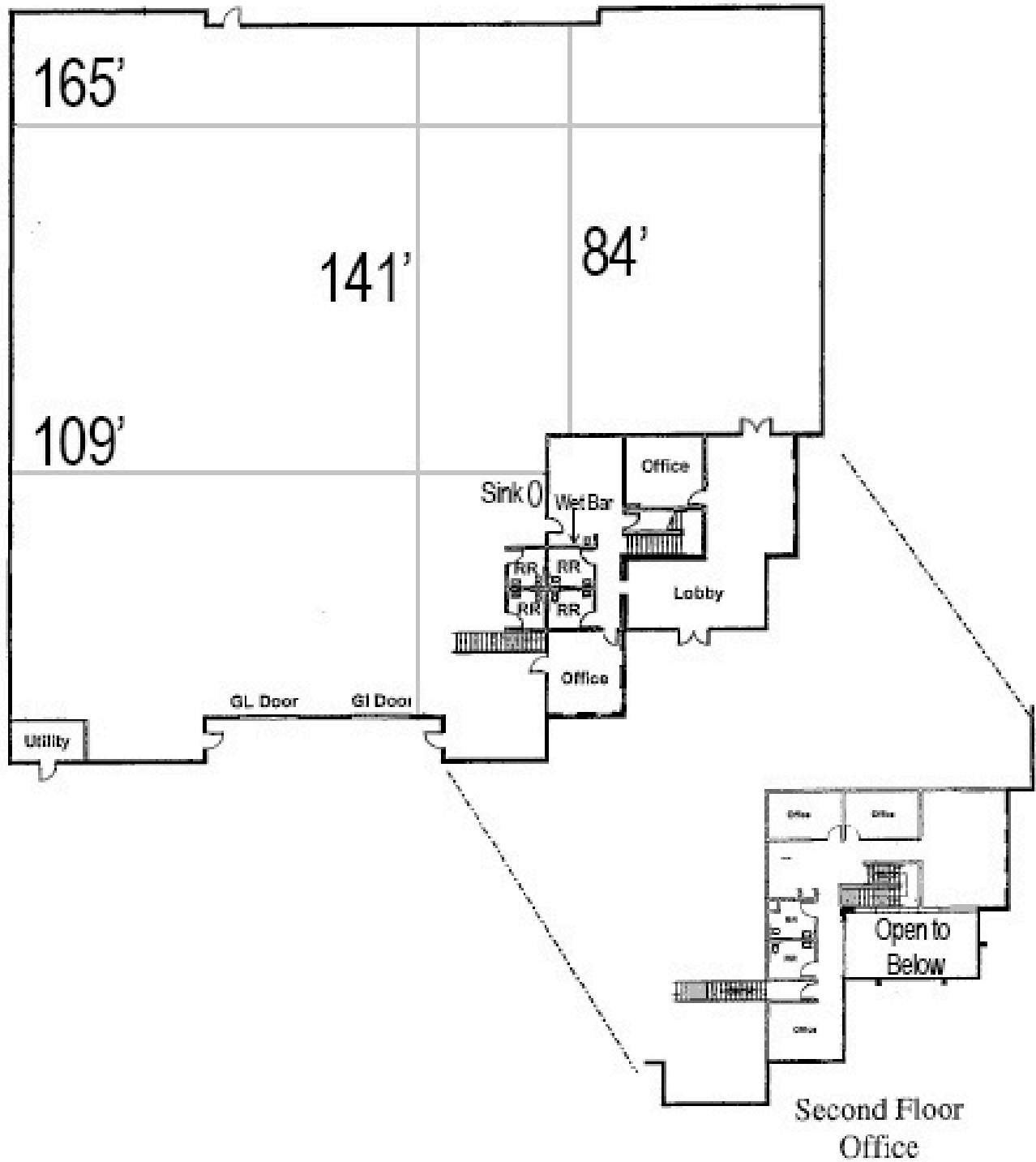

ROB JOHNSTON, President

Lic# 01121630
rob@johnston-pacific.com

LOUIS JOHNSTON, Vice President

Lic# 02054162
louis@johnston-pacific.com

To Schedule A Tour, Please
Contact Rob or Louis at:
949.366.2020
www.johnston-pacific.com



The information above had been obtained from sources believed to be reliable. While we do not doubt its accuracy, we have not verified it, make no guarantee, warranty or representation about it. It is your responsibility to independently confirm its accuracy and completeness. All information is subject to change without notice.