



1270 Puerta Del Sol, San Clemente, CA

Freestanding Industrial Building with Huge Yard

BUILDING FEATURES

- Building Size: ±10,500 SF
- Office Area: ±1,500 SF
- Warehouse Area: ±9,000 SF
- **Secured Yard: ±10,962 SF**
- 0.93 Acre Lot
- 3 Offices & Large Conference Room
- Room Lobby Retail/Training Area
- Private Parking Lot



JOHNSTON PACIFIC



View Website

ROB JOHNSTON, *President*

Lic# 01121630

rob@johnston-pacific.com

LOUIS JOHNSTON, *Vice President*

Lic# 02054162

louis@johnston-pacific.com

JOHNSTON PACIFIC
COMMERCIAL REAL ESTATE, INC.

PROPERTY PHOTOS

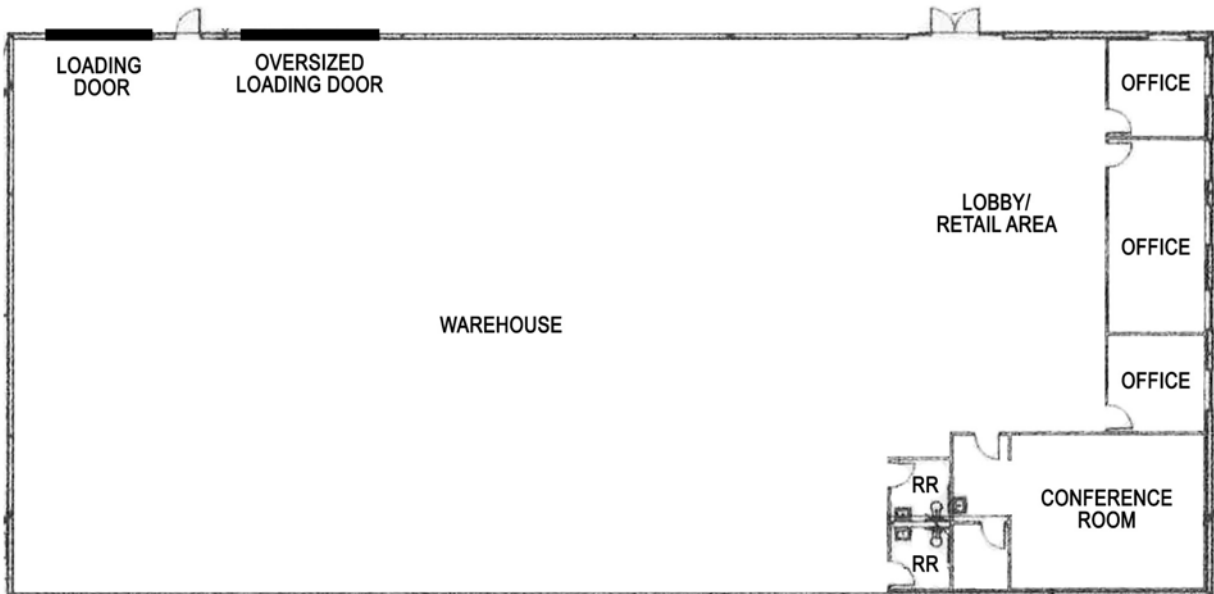

To tour this property contact Rob or Louis: 949.366.2020

SITE PLAN VIEW



JOHNSTON PACIFIC
COMMERCIAL REAL ESTATE, INC.

ROB JOHNSTON

President

Lic#01121630

rob@johnston-pacific.com

LOUIS JOHNSTON

Vice President

Lic# 02054162

louis@johnston-pacific.com



View Website

1305 CALLE AVANZADO
San Clemente, CA 92673

26240 ENTERPRISE COURT
Lake Forest, CA 92630

949.366.2020
www.johnston-pacific.com

The information above had been obtained from sources believed to be reliable. While we do not doubt its accuracy, we have not verified it, make no guarantee, warranty or representation about it. It is your responsibility to independently confirm its accuracy and completeness. All information is subject to change without notice.