

Small Industrial Building For Lease



Office/Warehouse Condo For Sale



Rob Johnston
Jim Wynne
949-366-2020

JOHNSTON PACIFIC
COMMERCIAL REAL ESTATE, INC.

The information above has been obtained from sources believed to be reliable. While we do not doubt its accuracy, we have not verified it, make no guarantee, warranty or representation about it. It is your responsibility to independently confirm its accuracy and completeness. All information is subject to change without notice. License #01121630

JOHNSTON PACIFIC

COMMERCIAL REAL ESTATE, INC.

1305 Calle Avanzado
San Clemente, CA 92673
949-366-2020

PRSR STD
U.S. POSTAGE
PAID
Laguna Niguel, CA
PERMIT NO. 400



- USDA Approved Food Commissary building for lease
- Separate lot
- Walk-in cooler, boiler, cooking hood, commercial sink & floor drains
- Ground level loading doors
- For details call 949-366-2020

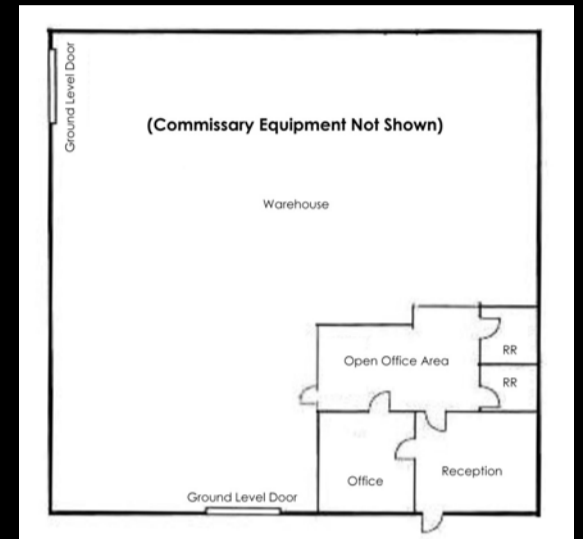
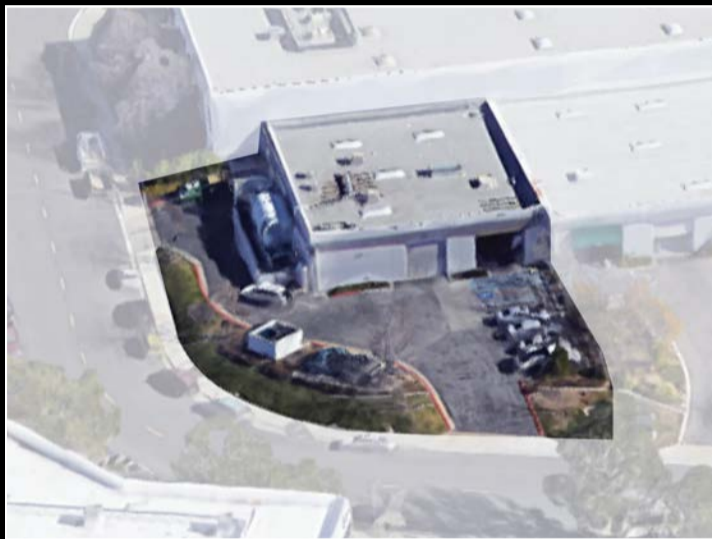

- Industrial condo for sale
- Two story windowed reception & offices
- Interior upgrades
- Ground level loading door
- For details call 949-366-2020

