

1,200 sq. ft. Office/Warehouse Unit For Lease



919 Calle Amanecer, Unit L, San Clemente

- 440 sq. ft. office area
- 760 sq. ft. warehouse area
- Reception area, office, restroom and warehouse
- Ground level loading door
- 13' warehouse clearance
- 100 amp power
- \$1.20 modified gross per sq. ft. plus \$106 CAM (\$1,546 per month)
- Available 12/1/15, call to tour

Rob Johnston
Jim Wynne

JOHNSTON PACIFIC
COMMERCIAL REAL ESTATE, INC.

949-366-2020

The information above has been obtained from sources believed to be reliable. While we do not doubt its accuracy, we have not verified it, make no guarantee, warranty or representation about it. It is your responsibility to independently confirm its accuracy and completeness. All information is subject to change without notice.

919 Calle Amanecer, Unit L, San Clemente

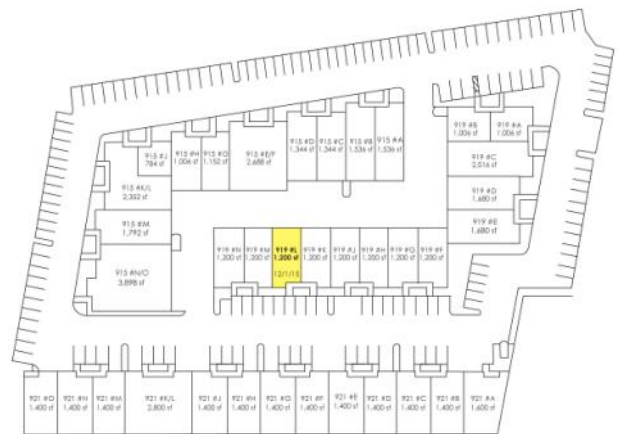
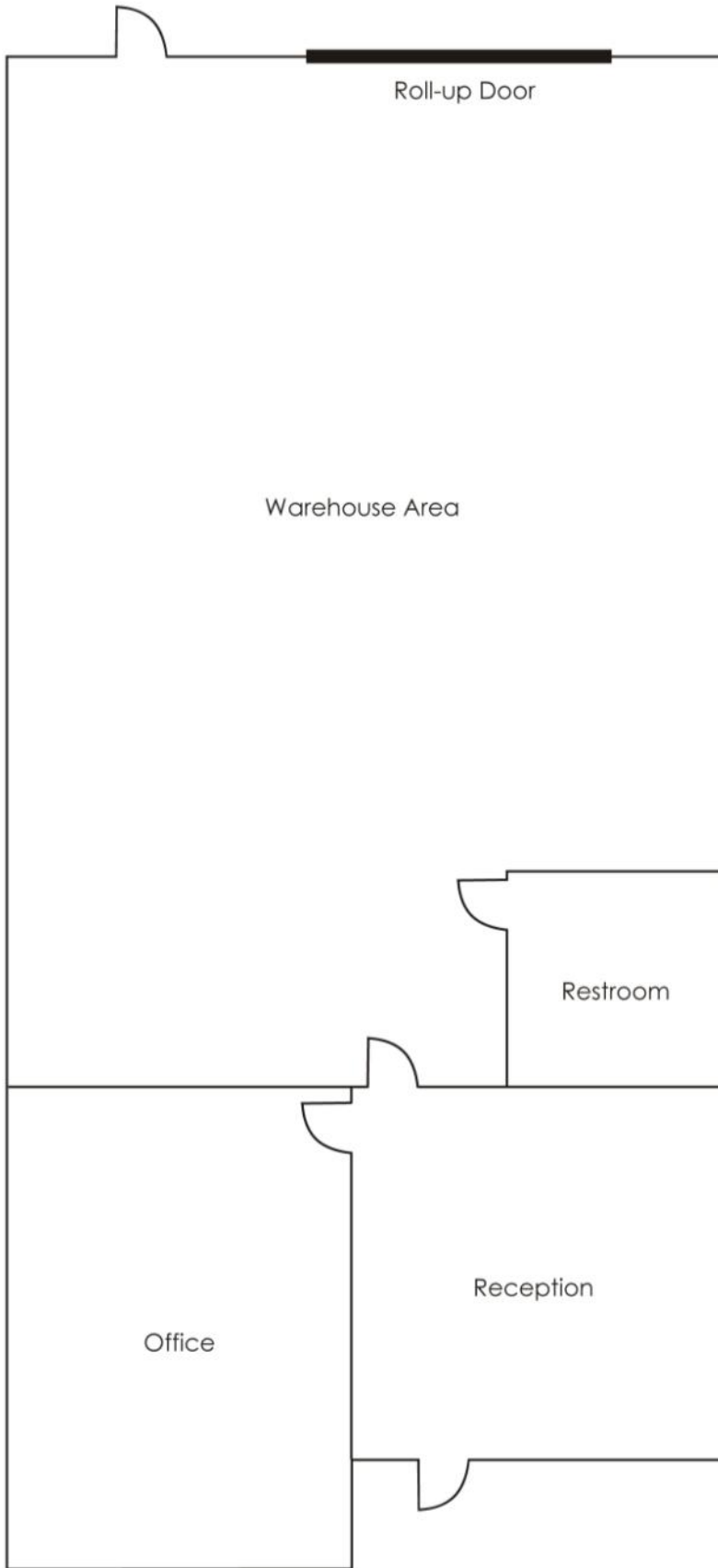

Rob Johnston
 Jim Wynne
 949-366-2020
www.johnston-pacific.com
 License #01121630

JOHNSTON PACIFIC
 COMMERCIAL REAL ESTATE, INC.

The information above has been obtained from sources believed to be reliable. While we do not doubt its accuracy, we have not verified it, make no guarantee, warranty or representation about it. It is your responsibility to independently confirm its accuracy and completeness. All information is subject to change without notice.