

# 1,400 or 1,792 sq. ft. Office/Warehouse Units **For Lease**



- Various size units
- Ground level loading door
- 14 ft. warehouse clearance
- Freeway close



Rancho San Clemente Business Center  
915, 919, 921 Calle Amanecer, San Clemente

**JOHNSTON PACIFIC**  
COMMERCIAL REAL ESTATE, INC.

The information obtained above has been obtained from sources believed to be reliable. While we do not doubt its accuracy, we have not verified it, make no guarantee, warranty or representation about it. It is your responsibility to independently confirm its accuracy and completeness. All information is subject to change without notice.

Rob Johnston • Jim Wynne • Xavier Nolasco

949-366-2020  
1305 Calle Avanzado, San Clemente, CA 92673  
[www.johnston-pacific.com](http://www.johnston-pacific.com)  
License #01221630

# Rancho San Clemente Business Center

## Office/Warehouse Units For Lease

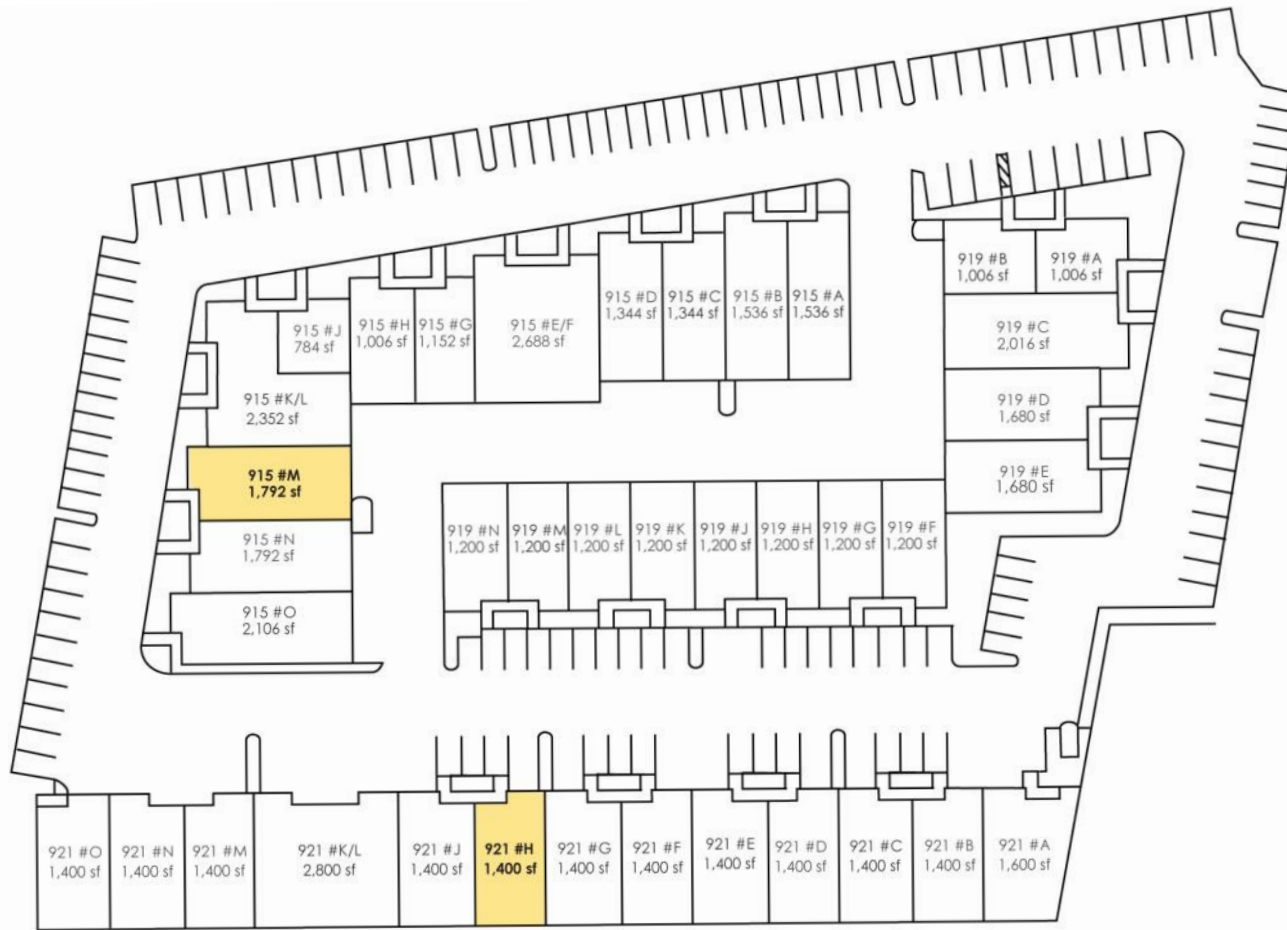

### Available Units

Unit	Size	Base Rent	CAM* Monthly	Monthly Total
921 #H	1,400 sf	\$1,610	\$124	\$1,734
915 #M	1,792 sf	\$2,061	\$159	\$2,220

\*Common Area Maintenance charge includes trash, water and landscaping.



**JOHNSTON PACIFIC**  
COMMERCIAL REAL ESTATE, INC.

The information obtained above has been obtained from sources believed to be reliable. While we do not doubt its accuracy, we have not verified it, make no guarantee, warranty or representation about it. It is your responsibility to independently confirm its accuracy and completeness. All information is subject to change without notice. 3/13/14

Rob Johnston • Jim Wynne • Xavier Nolasco

949-366-2020  
1305 Calle Avanzado, San Clemente, CA 92673  
www.johnston-pacific.com  
License #01221630